

Tomb no. GB 15 (Gabra no. T 5/SS)

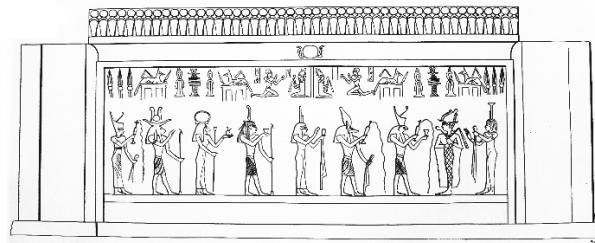

Relief of the tomb enclosure

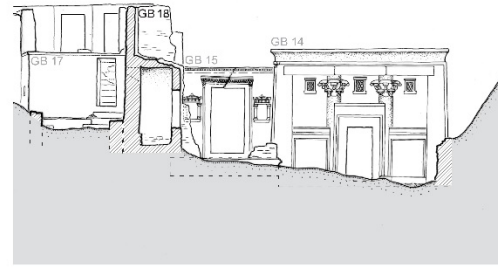

0 1 5 10 15m

Tuna el-Gebel, Petosiris-Nekropole
Ansicht GB 14/15 - ohne Maßstab -

BTU Cottbus
LS Baugeschichte / LS Vermessungskunde
Juni 2011 / OC CW TM

Lehmziegelmauem

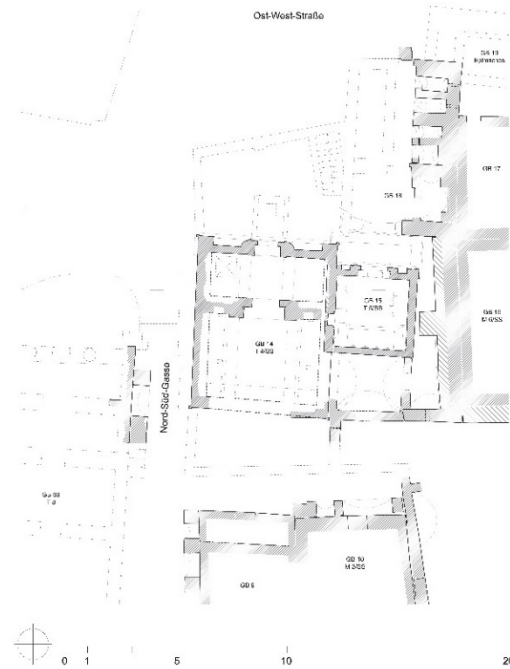

0 1 5 10 20m

Tuna el-Gebel, Petosiris-Nekropole
Grundriss GB 14-15 - ohne Maßstab -

BTU Cottbus
LS Baugeschichte / LS Vermessungskunde
Juni 2011 / JM CW TM

Lehmziegelmauem
Steinmauem
moderne Mauern

Date of construction

Last decades of 1st century AD

Names of the deceased

unknown

Construction material

Local limestone ('Muschelkalk'); the ceiling was probably built with mud bricks

Number of burials

At least 3 (tomb enclosure, two burials in the floor)

Tomb no. GB 15 (Gabra no. T 5/SS)

Number of floors	1 on a podium
Number of rooms	1
Number of niches	2 in the western wall (used for urns or canopies?)
Decoration	Façade: Greek ornaments in Ionic (door frame) and Doric-Corinthian style (frames of the niches) Inside: Tomb enclosure with an Egyptian relief
Inscriptions	None; inside was found a stela of Pa-Isis (Cairo University Museum (inv. no. 1609)
Bibliography	K. Lembke - Ch. Wilkening, Egyptian in disguise – Ein römisches Tempelgrab in Tuna el-Gebel, in: <i>Études et Travaux</i> 25, 2012, 172-188 (with further literature)

Author: K. Lembke