

# Tomb no. GB 14 (Gabra no. T 4/SS)

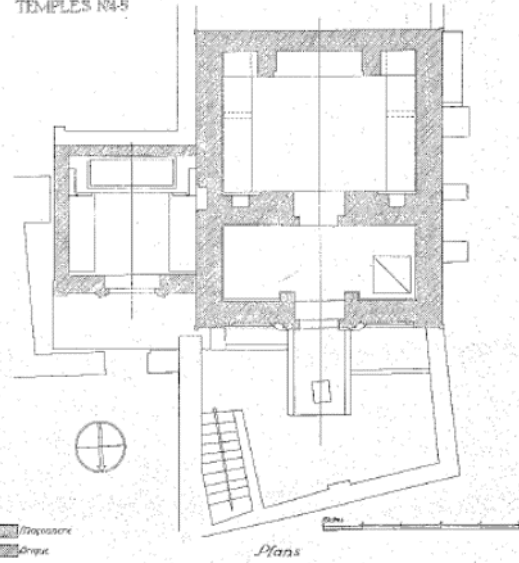

SECTEUR SUD  
TEMPLES N°4-5



Plan Gabra 1941

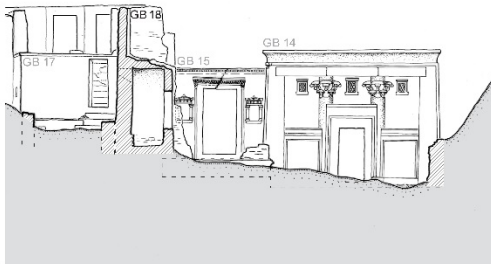

0 1 5 10 15m

**Tuna el-Gebel, Petosiris-Nekropole**  
Ansicht GB 14/15 - ohne Maßstab -

BTU Cottbus  
LS Baugeschichte / LS Vermessungskunde  
Juni 2011 / OC CW TM

Lehmziegelmauern

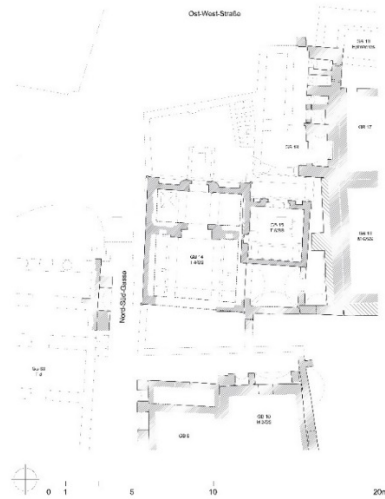

**Tuna el-Gebel, Petosiris-Nekropole**  
Grundriss GB 14-15 - ohne Maßstab -

BTU Cottbus  
LS Baugeschichte / LS Vermessungskunde  
Juni 2011 / JM CW TM

Lehmziegelmauern  
Steinmauern  
neuere Mauern

Date of construction

1<sup>st</sup> century BC – 1<sup>st</sup> century AD

## Tomb no. GB 14 (Gabra no. T 4/SS)

<b>Names of the deceased</b>	unknown
<b>Construction material</b>	Local limestone ('Muschelkalk')
<b>Number of burials</b>	4 loculi in the 2 <sup>nd</sup> room + shaft with unknown number of burials in the 1 <sup>st</sup> room
<b>Number of floors</b>	1
<b>Number of rooms</b>	2
<b>Number of niches</b>	2 in the northern wall of the 2 <sup>nd</sup> room
<b>Decoration</b>	Façade: Egyptian ornaments (false fences, false windows, lily capitals, torus and cavetto)
<b>Inscriptions</b>	None; according to Gabra et al. 1941, 60 the false fences were covered with stucco and painted in black with a reed pen (pictures or inscriptions)
<b>Bibliography</b>	K. Lembke - Ch. Wilkening, Egyptian in disguise – Ein römisches Tempelgrab in Tuna el-Gebel, in: Études et Travaux 25, 2012, 172-188 (with further literature)